



2010-11

ORDER FORM

Name _____

Address _____

City State Zip _____

Phone (Day) _____

Phone (Evening) _____

Email _____

Tickets may be purchased by phone (815) 534-3240 with a credit card or by mail **only**. The box office is open on the day of the performance **only**. Performances typically sell out well in advance.

- My check is enclosed payable to **Lincoln-Way District 210**
- Charge my order to a credit card (MasterCard, Visa, or Discover)

Card No. _____

Expiration Date _____

Signature _____

All Sales are Final. No Refunds or Exchanges.
Artist and dates subject to change.

MAIL ORDER TO:
L-W North High School
 Attention: District 210
 1900 South Harlem Avenue
 Frankfort, IL 60423
 Phone: (815) 534-3240
 www.lw210.org/seniorseries

LINCOLN-WAY DISTRICT 210
 PRESENTS

SeniorSeries

SeniorSeries
 Lincoln-Way North Performing Arts Center

JOIN US FOR THE LINCOLN-WAY DISTRICT 210 SENIOR SERIES

PERFORMANCE	PRICE	TICKETS TO GO
Tom Dreesen	\$15	
The Chenille Sisters	\$12	
United We Stand		
Big Band Romance	\$10	
Saint Sinners	\$10	
Benny Goodman Tribute	\$12	
GRAND TOTAL		

Seating is general admission beginning at 10:00 a.m. Groups of 15 or more will have designated seating. Wheelchair patrons will have designated seating, provided they inform Lincoln-Way in advance. Patrons with walkers, canes, macular degeneration, or on oxygen will have the opportunity to enter the auditorium accompanied by one companion prior to 10:15 a.m. Patrons who require special accommodations should arrive by 10:00 a.m.

- Wheelchair
- Walker
- Cane
- Macular Degeneration
- Oxygen
- Other _____

JOIN US FOR THE LINCOLN-WAY DISTRICT 210 SENIOR SERIES

PERFORMANCE	PRICE	TICKETS	TOTAL
Tom Dreesen	\$15	___	___
The Chenille Sisters	\$12	___	___
United We Stand	\$10	___	___
Big Band Romance	\$10	___	___
Saints & Sinners	\$10	___	___
Benny Goodman Tribute	\$12	___	___
GRAND TOTAL		___	___

JOIN US FOR THE LINCOLN-WAY DISTRICT 210 SENIOR SERIES

PERFORMANCE	PRICE	TICKETS	TOTAL
Tom Dreesen	\$15	___	___
The Chenille Sisters	\$12	___	___
United We Stand	\$10	___	___
Big Band Romance	\$10	___	___
Saints & Sinners	\$10	___	___
Benny Goodman Tribute	\$12	___	___
GRAND TOTAL		___	___

Seating is general admission beginning at 10:15 a.m. Groups of 15 or more will have designated seating. Wheelchair patrons will have designated seating, provided they inform Lincoln-Way in advance. Patrons with walkers, canes, macular degeneration, or on oxygen will have the opportunity to enter the auditorium accompanied by one companion prior to 10:15 a.m. Patrons who require special accommodations should arrive by 10:00 a.m.

Seating is general admission beginning at 10:15 a.m. Groups of 15 or more will have designated seating. Wheelchair patrons will have designated seating, provided they inform Lincoln-Way in advance. Patrons with walkers, canes, macular degeneration, or on oxygen will have the opportunity to enter the auditorium accompanied by one companion prior to 10:15 a.m. Patrons who require special accommodations should arrive by 10:00 a.m.

- Wheelchair
- Walker
- Cane
- Macular Degeneration
- Oxygen
- Other _____

- Wheelchair
- Walker
- Cane
- Macular Degeneration
- Oxygen
- Other _____

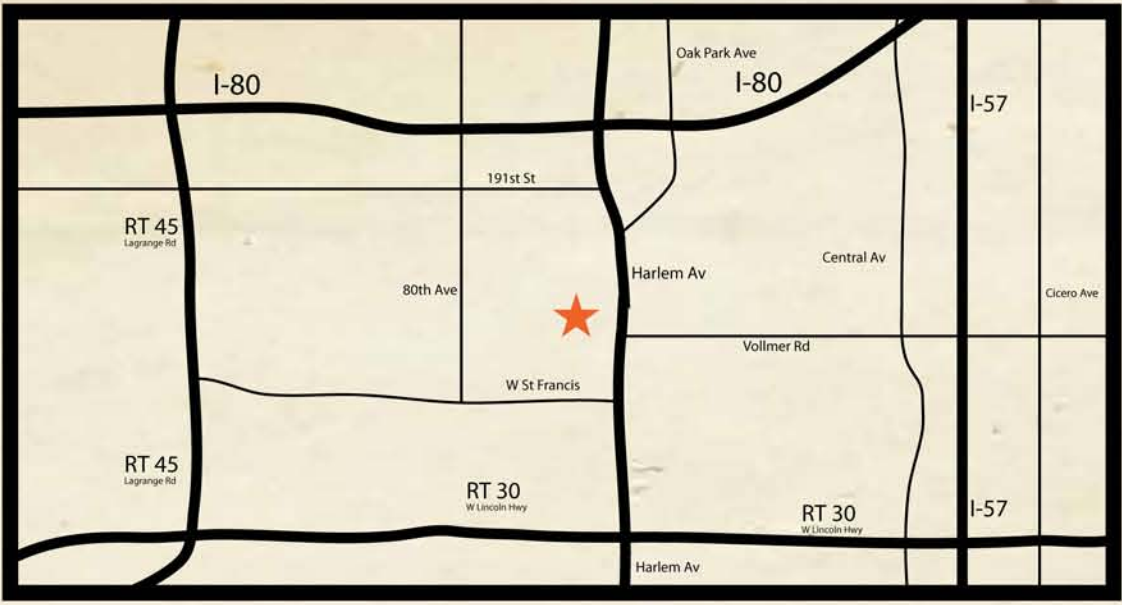

Lincoln-Way North Performing Arts Center
 Located at the corner of Harlem Avenue and Vollmer Road.
 Free parking close to the theatre entrance, door #46.

For more information, please visit www.lw210.org/seniorseries

LINCOLN-WAY DISTRICT 210
 PRESENTS
SeniorSeries

L-W North High School
 19900 South Harlem Avenue
 Frankfort, Illinois 60423

LINCOLN-WAY DISTRICT 210
 PRESENTS THE
 2010 - 2011

SeniorSeries





2010-11 ORDER FORM

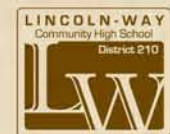

2010-11 ORDER FORM

Name _____
Address _____
City State Zip _____
Phone (Day) _____
Phone (Evening) _____
Email _____

Name _____
Address _____
City State Zip _____
Phone (Day) _____
Phone (Evening) _____
Email _____

Tickets may be purchased by phone (815) 534-3240 with a credit card or by mail only. The box office is open on the day of the performance only. Performances typically sell out well in advance.

Tickets may be purchased by phone (815) 534-3240 with a credit card or by mail only. The box office is open on the day of the performance only. Performances typically sell out well in advance.

My check is enclosed payable to **Lincoln-Way District 210**

Charge my order to a credit card (MasterCard, Visa, or Discover)

Card No. _____
Expiration Date _____ Sec. Code _____
Signature _____

My check is enclosed payable to **Lincoln-Way District 210**

Charge my order to a credit card (MasterCard, Visa, or Discover)

Card No. _____
Expiration Date _____ Sec. Code _____
Signature _____

All Sales are Final. No Refunds or Exchanges. Artist and dates subject to change.

All Sales are Final. No Refunds or Exchanges. Artist and dates subject to change.

MAIL ORDERS TO:
L-W North High School
Attention: Denise Adducci
1990 South Harlem Avenue
Frankfort, Illinois 60423
Phone: 815-534-3240
www.lw210.org/seniorseries

LINCOLN-WAY DISTRICT 210 PRESENTS
Senior Series

MAIL ORDERS TO:
L-W North High School
Attention: Denise Adducci
1990 South Harlem Avenue
Frankfort, Illinois 60423
Phone: 815-534-3240
www.lw210.org/seniorseries

LINCOLN-WAY DISTRICT 210 PRESENTS
Senior Series

LAUGHTER AND MEMORIES OF SINATRA

with comedian Tom Dreesen
Wednesday, September 22, 2010
11 a.m. • \$15.00

In this unforgettable performance comedian, Tom Dreesen, will take you from his childhood of shining shoes in bars in his hometown of Harvey, Illinois, hearing Sinatra on the jukebox singing *Come Fly With Me* to one day touring the nation in Sinatra's private jet as his opening act for 13 years. Tom's keen insight into arguably the greatest career that show business has ever known and the lessons he learned from the legendary star, promises to be a moving experience. Tom has made over 500 appearances on TV as a stand-up comedian, including over 60 appearances on the *Tonight Show*, has been a frequent and favorite guest of David Letterman and host in David's absence, and is a regular in all the main showrooms in Las Vegas. With excellent material, superb delivery and impeccable timing, it is easy to see why Tom is the quintessential comedian!
"Brilliant, funny, poignant"
- *Chicago Tribune*

THE CHENILLE SISTERS

with the Royal Garden Trio
Wednesday • October 20, 2010
11 a.m. • \$12.00

The Chenille Sisters' sound, reminiscent of the Andrews, Boswell, and McGarrigle Sisters, is a blending of three uniquely gifted souls into a musical phenomenon that's poignant, funny, and entertaining. What these three women have in common are heavenly voices with exquisite harmony featuring witty wisdom and a passion for connecting with their audiences. The Chenille Sisters are teaming up with the traditional and gypsy jazz sound of the Royal Garden Trio featuring cello, guitars, and clarinet. Both groups have a deep love for 1930s and 1940s jazz, and they have put their talents together into a rich collaboration with great tunes like *Mood Indigo, Dinah, Butter and Egg Man, Yesterdays*, and many more. The Chenille Sisters and the Royal Garden Trio highlight bygone days with a big dose of modern attitude and humor.
"...beautifully harmonized repertoire... irreverent, loose humor... plenty of reason to both listen and laugh."
- *Washington Post*

UNITED WE STAND

Wednesday • November 10, 2010
11 a.m. • \$10.00

Back by popular demand is vocalist, Nancy Hays, with a performance that celebrates our great nation and our veterans. Accompanied by her long-time pianist/conductor, Robert Benson and his swing ensemble, Nancy will sing classic patriotic American standards including *God Bless America, America the Beautiful*, and our own *National Anthem*. The program will feature rarely heard gems from the 1940s and Broadway songs by George M. Cohan. The show also includes the Andrew Sisters' song *Boogie Woogie Bugle Boy, This Land is Your Land, God Bless the USA*, and many, many more. Having performed from sea to shining sea, the Reagan Center in Washington, D.C. to Hawaii for thousands of US military and members of the American Legion, Nancy delights audiences with her expressive vocals that lend unique style and depth to the music and lyrics of America's greatest patriotic songwriters.

BIG BAND ROMANCE

Wednesday • February 9, 2011
11 a.m. • \$10.00

Celebrate Valentine's Day with vocalist Peter Oprisko, the man with over 700 love songs in his repertoire. Passionate presentation, elegant style, and an extraordinary ability to connect and interact with audiences have garnered fans and admirers nationwide. Backed by a 12-piece orchestra, Peter will perform romantic songs such as *The Way You Look Tonight, I Wish You Love, On a River, Secret Love, My Funny Valentine, True Love*, and *There's a Small Town*. Peter utilizes a musical mix to tell the story of the songs and the artists who brought them to life. The performance is further enhanced by a talented couple performing such classic dances as the waltz, foxtrot, rumba, and the tango. A special Valentine treat for the eyes and ears!

SAINTS & SINNERS

Wednesday • March 16, 2011
11 a.m. • \$12.00

Just in time for St. Joseph's Day and St. Valentine's Day is the latest sequel in the *Saints & Sinners* series, *Saints & Sinners*, which introduces Mother Superior, the new nun in town. Mother Superior's ruler is quick, her aim is spot-on, and she wants to know who in the audience is a saint and who is a sinner! Mother Superior is called by the parish to St. Bruno's to help in fundraising. The economy is tough, donations are down, and someone has to save the parish! Her clever idea: a calendar of famous saints and famous sinners. This interactive comedy has the audience involved in choosing which saints and which sinners should go in the calendar. Being a nun, Mother Superior has lots of opinions on Catholicism in general and who makes the calendar cut...St. Valentine looks good but Judas is definitely out. As always each performance is unique and will appeal to people of all faiths.
"Good-natured humor"
- *Chicago Reader*

DAVE BENNETT'S "TRIBUTE TO BENNY GOODMAN"

Wednesday • April 6, 2011
11 a.m. • \$12.00

Clarinet virtuoso, Dave Bennett, and his All-Star Septet bring to life the music of "The King of Swing" with incredible technique, expression, and sensitivity. The extraordinary re-creation of the sounds and artistry of Benny Goodman come alive when Bennett and his band perform some of the favorites including *Moonglow, I Got Rhythm, Don't Be That Way, Stompin' at the Savoy, Goody Goody, and Sing Sing Sing*. Vocals made famous by such Goodman singers as Peggy Lee and Helen Forrest are brought to life by jazz singer, Anne Seabury. Bennett's mature stage presence (even though he is only in his mid-twenties), knowledge of dates and details of Goodman recordings, plus his penchant for wire-rim glasses, spats, and double-breasted suits will transport audiences back to the time and mood of Benny Goodman's "Swing Era!"
"Dave Bennett's emulation of Benny Goodman is truly a compliment to the Master."
- *Bill Hyland, Trustee of the Estate of Benny Goodman*